

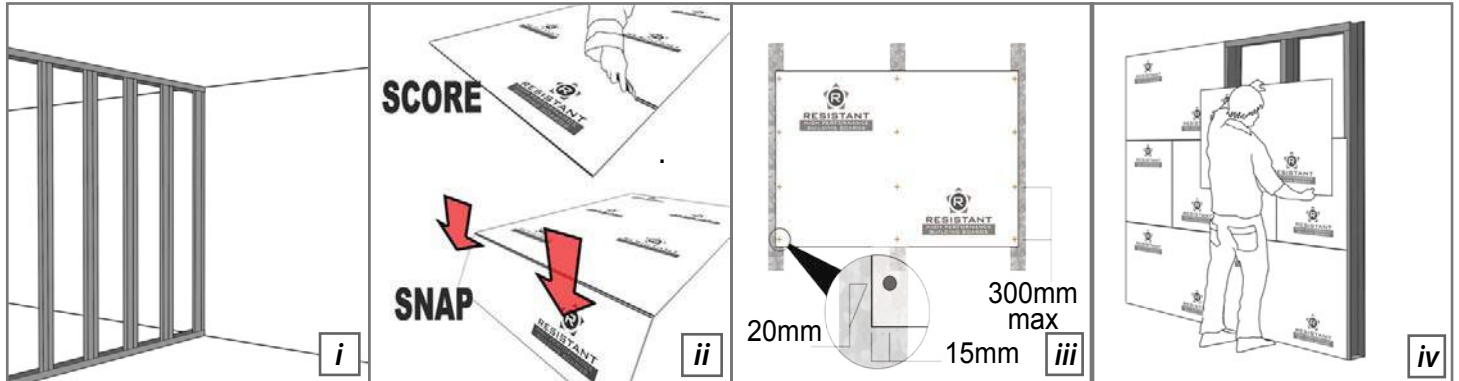

## Fixing Guide



### PREPARATION

#### Studwork

Multi-Pro MoistSure board can be attached to either timber or steel studwork, depending on the nature of the job. Steel studwork has advantages in that it is lighter, generally faster to install and has better acoustic properties. The layout of the partition is similar for both systems. (figure i)

#### Fixings

Stainless Steel Screws or Hot dipped galvanised screws should be chosen at all times. Screws should be attached commencing at the centre and working outwards towards the edges.

#### Multi-Pro MoistSure Board

Multi-Pro MoistSure boards come in 3 sizes suitable for floors and walls. Full sheet sizes are available also 1200 x 2400mm (6mm & 12mm).

#### Wall boards

12 x 800 x 1200mm (Maximum 600mm c/c)  
There is no need for horizontal studs, as the boards can carry heavy loads without additional support.  
\*Up to 100kg/m<sup>2</sup> of tiles and adhesive\*

#### Floor boards

6 x 590 x 1195mm  
6 x 1200 x 1220mm

#### Cutting

In the case where boards may need to be custom cut to size, sheets are easily cut using the 'Score & Snap' method (figure ii). Mark out the desired size on the board with a pencil and rule. Score along the mark with a utility knife making sure to slice the glass fibre mesh, then simply press the board downwards snapping it at 'Score & Snap' line. Smooth and tidy up edges with a light abrasive.

For areas of fitting and fixtures, cut-outs should be done before installing the board. RESISTANT always recommend the use of a dust mask

### FIXING

#### Wall Attachment

Multi-Pro MoistSure boards are attached onto the vertical studs in a symmetrical fashion each side of the partition. They should be attached horizontally on the subframe, with fixings at 300mm maximum centres vertically and 600mm maximum centres horizontally. Space fixings a minimum of 15mm from the edge and 20mm from the corner of the board (figure iii). When fixing, start at the centre and work outwards to prevent distortion within the boards.

The boards should be offset so that four corners never meet at one point (figure iv). If there is a chance that there could be movement in the stud or building then fix further boards allowing a 2mm gap between edges. A 6mm gap should be left above the finished floor level to allow for settling of the frame or movement.

#### Floor Attachment

Ensure sub-floor is not damaged and replace if necessary. Make certain there is a clean and even surface before laying Multi-Pro MoistSure, staggering all the joints and ensuring they don't align with Sub-Floor joints. Never allow four corners of boards to meet at one point. Apply an even layer of Tile adhesive, with a suitable trowel, to the subfloor before setting Multi-Pro MoistSure firmly and evenly in place. Secure one board at a time, fixing screws at 300mm centres ensuring nail heads are flush with the surface (figure v.) **Multi-Pro MoistSure is suitable for underfloor heating.**

#### Tanking Detail (Optional)

A 6mm gap is left between the bottom of the board and the level of the floor; this is filled with a high modulus water resistant flexible adhesive (figure vi). In and around the shower tray area and wet rooms.



## Fixing Guide

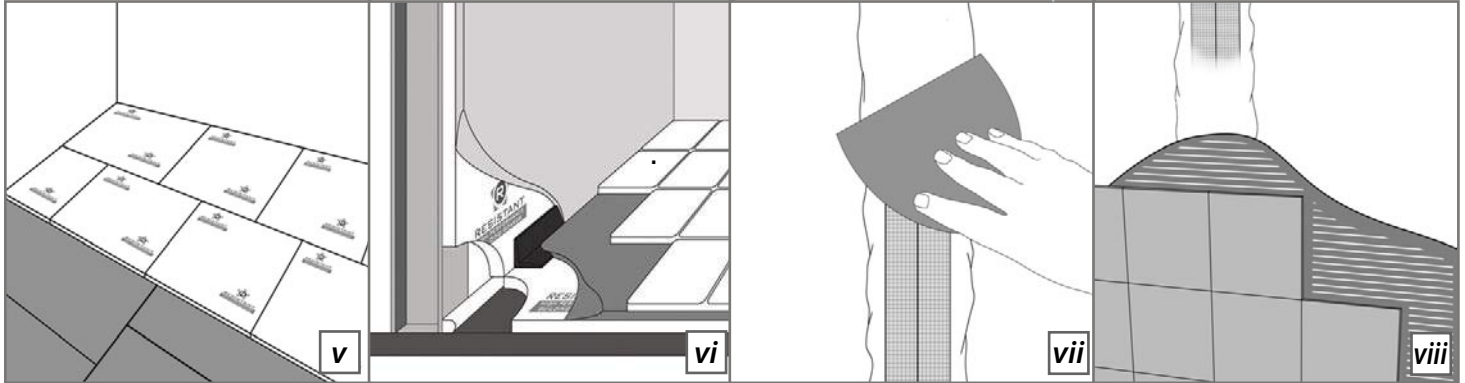

### FINISH

The Multi-Pro MoistSure board should be fixed the rough side out, as this will give better adhesion to the tile adhesive.

#### Sheet Jointing & Taping

Before applying the final finish layer, the joints should be embedded with a flexible tile adhesive and 50mm alkaline resistant tape to provide extra strength (figure vii).

#### Tiling

Boards should be sealed on all sides with an acrylic based primer.

Apply tile adhesive in accordance with the manufacturer's guidelines. Bed the tiles as per good building practice, allowing normal spacing to grout once the bedding adhesive is dry (figure viii).

**The board has been tested to hold up to 100kg/m<sup>2</sup> of tiles including adhesive.**

#### Paint / Wallpaper

Boards can be painted with emulsion or oil based paints. Advice from coatings' manufacturers regarding surface preparation, sealing and finish coat should be adhered to (figure ix)

#### Fixtures & Fittings

When attaching heavy objects, all fixings should be made directly into studs or into a nogging fixed firmly between the studs.

***RESISTANT recommend using Multi-Pro MoistSure throughout the bathroom, not only in shower / wet areas. This will help with the continuing battle against mould and mildew and help to extend the longevity of your bathroom.***



## Fixing Guide

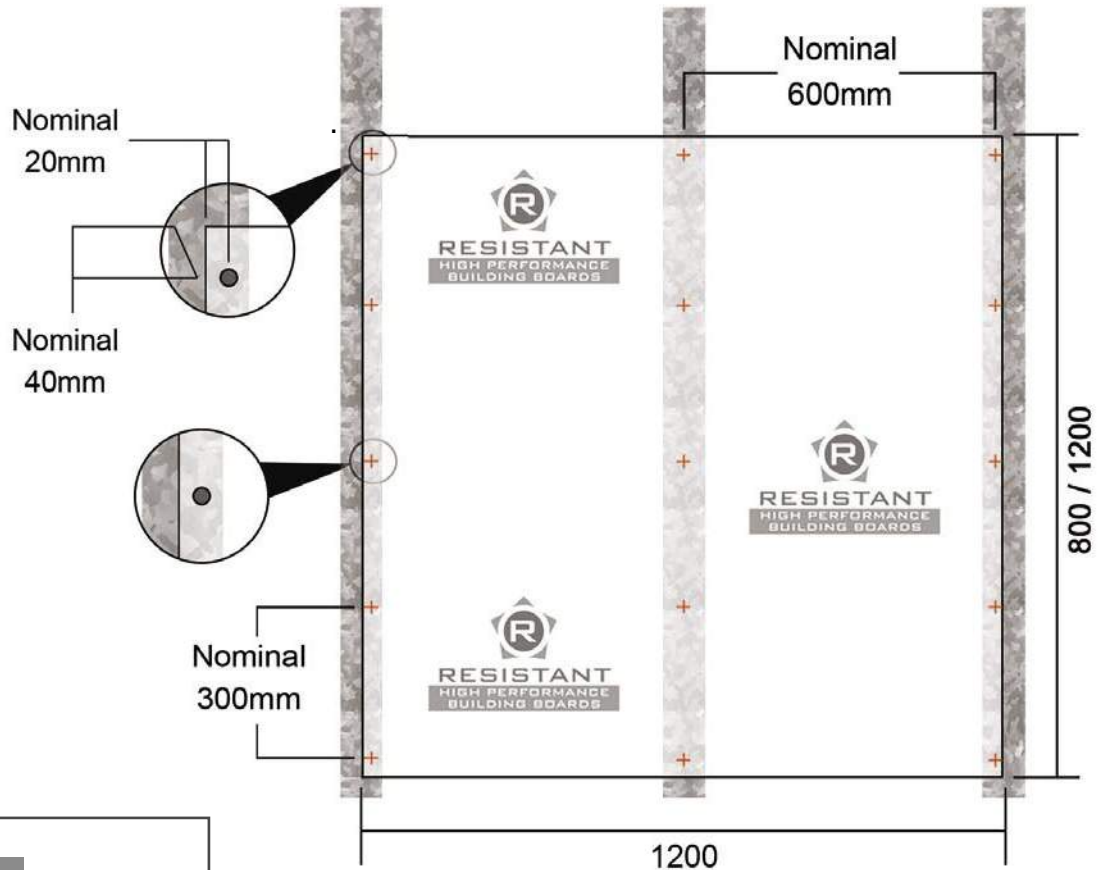

### Metal Stud

Case Hardened  
Stainless Steel

Self tapping screw  
Countersunk Head



### Timber Stud

Wood Screw  
Stainless Steel or  
Hot dipped  
Galvanised,  
Self tapping screw  
Countersunk Head

